

# SPECIFICATION SHEET

## 2 Drawer Sink Provision Base Cabinet with Inlay Rails

Code: MK120-CIR



### Features

- 2 Drawer Sink Provision Base Cabinet
- Cabinet with Inlay Rails
- Laminate Woodgrain & Solid Colours on MR Board
- **Default Dimensions** (as pictured):  
W600 x H880 x D590

### Variable Dimensions:

Width: 600-900mm  
Depth: 520-650mm

*Note: For measurements outside the variable dimensions, please contact us.*

### Technical Details

Note: All measurements shown are in millimetres. Sizes are nominal.

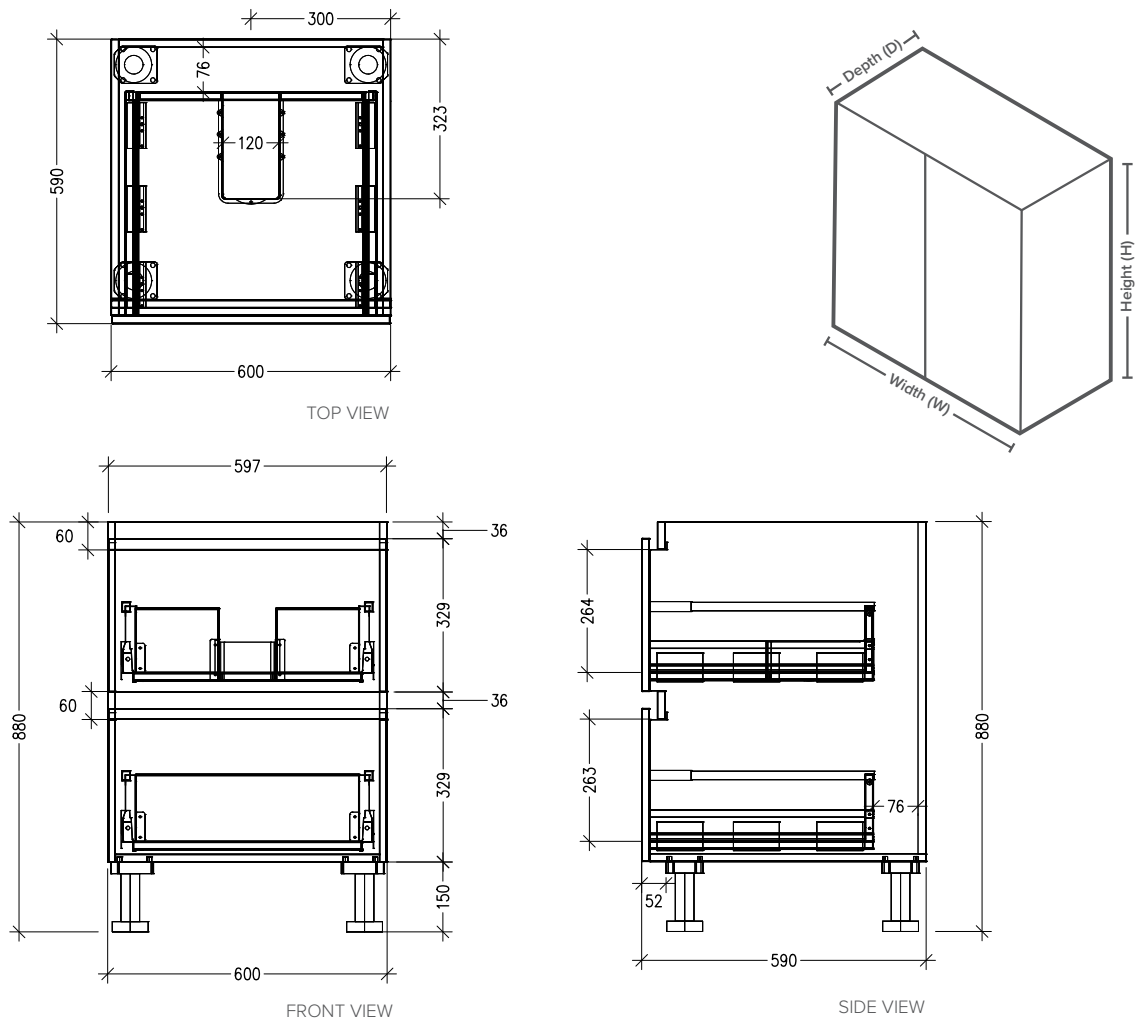

Head Office: 30 Mill Road, Whanganui  
0800 122 522 | sales@smartcab.co.nz  
[www.smartcab.co.nz](http://www.smartcab.co.nz)